



**Sanitary lobe
pumps**



BOMBAS BOYSER, S.L.

Is a Spanish company specialising in the manufacture of peristaltic and lobe pumps for industrial use. Originally founded in 1993, the company currently supplies a large selection of both peristaltic and rotary lobe pumps, all complemented by an equally wide range of applications, flow configurations and pump-related solutions for use in industry.

We distribute our products on all five continents via a network of more than thirty distributors, with the corresponding guarantees of impeccable assistance and after-sales service – wherever you might be.

This catalogue provides a general overview of our products, along with their technical details. You will also quickly become aware of the personal commitment that we invest in the fine-tuning of quality, as part of our effort to create customer satisfaction based on our outstanding industrial products; with all our endeavours dedicated to the development and manufacture of the items presented here.

Why choose sanitary lobe pumps?

Operating principle

The operating principle of a lobe pump is based on the accurate movement of its rotors, which in turn depends on the perfectly regulated synchronisation of a corresponding set of high precision gears.

The result is a positive-displacement volumetric pump with exceptional performance.

The concept of the sanitary version that concerns us here has been engineered to ensure exceptional reliable performance with a focus on easy maintenance. The synchronization of precision gears eliminates any contact of its high precision rotors, there is absolutely no change of any metal component touching another and the fluid being handled only ever comes in contact with AISI-316L stainless steel.

The sanitary design has been engineered to suit the high standards required for food and beverage applications where cleaning or sterilisation in place is a requirement.

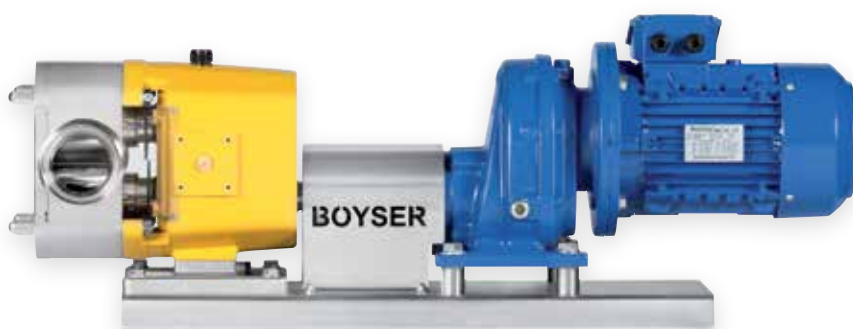

Main features:

- Easy to clean and maintain
- Mechanical seals designed for sanitary use and easy to remove from the front
- Reversible rotation
- Can be fitted in a vertical or horizontal position
- Absolutely all components that come into contact with the product are made of AISI-316L stainless steel
- Suitable for fluids of any viscosity
- Operating pressures of up to 12 bar
- Continuous flow (non-pulsed)

Examples of use:

- Dairy products, wine, sauces, jams and marmalades, fruit juices, honey, chocolate, syrups, concentrates, mayonnaise, liquid egg, oil products, glucose, caramel, spirits and liqueurs, flavourings, creamed products, ketchup, mustard, etc.
- Cosmetic creams, shampoo, lotions, perfumes, essential oils, gels, ointments, toothpaste, emulsions, glycerine, detergents, etc.
- Injectable substances, serum, saline solutions, liquid medicines, syrups, vitamins, etc.

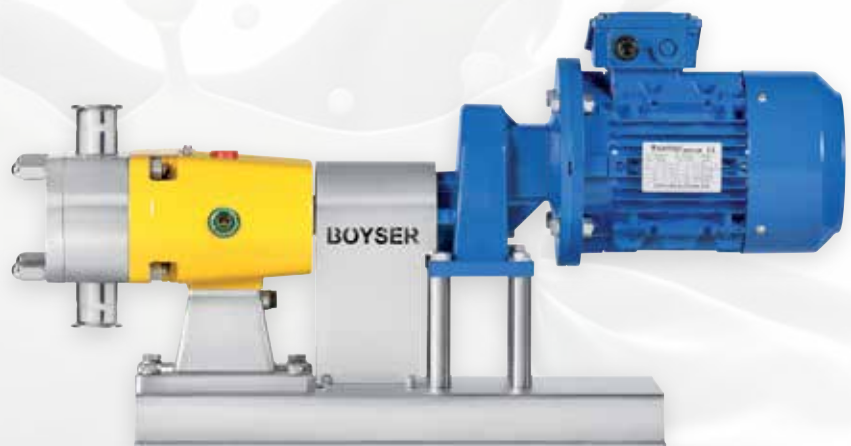

Boyser sanitary lobe pumps **LIS SERIES**

Lobe pump designed for sanitary use

Robust and highly versatile suitable for general use in all manner of food-sector, chemical, cosmetic and industrial applications.

Easy to clean and maintain in place on the production line; can be installed vertically or horizontally.

All parts that come into contact with the product are made of AISI-316L stainless steel with a standard surface roughness of $Ra \leq 0.8 \mu m$. Standard version with DIN 11851 NW connections, mechanical seals made of silicon carbide, graphite, EPDM, with tri-lobe type rotors.

Main options:

- Connections in Tri-clamp, SMS, BSP or NPT configuration, with others available under request.
- Bi-lobe rotors in dual wing configuration
- Mechanical seals in silicon carbide / silicon carbide
- Sealing gaskets in NBR or FKM.
- Safety by-pass valve on front cover or between connections.
- Rectangular feed inlet.
- Heat insulating/cooling jacket.





Performance curve:

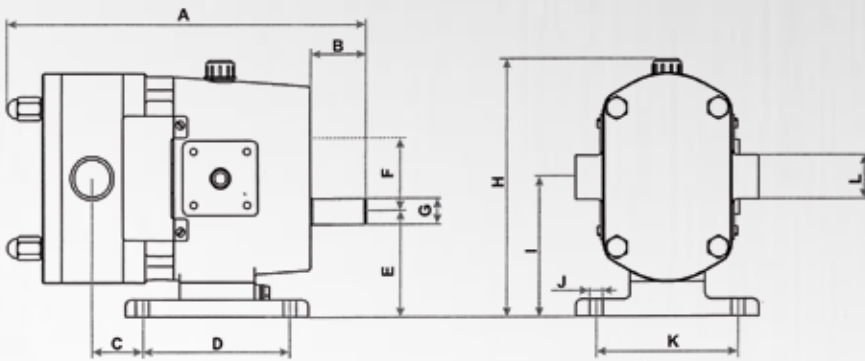
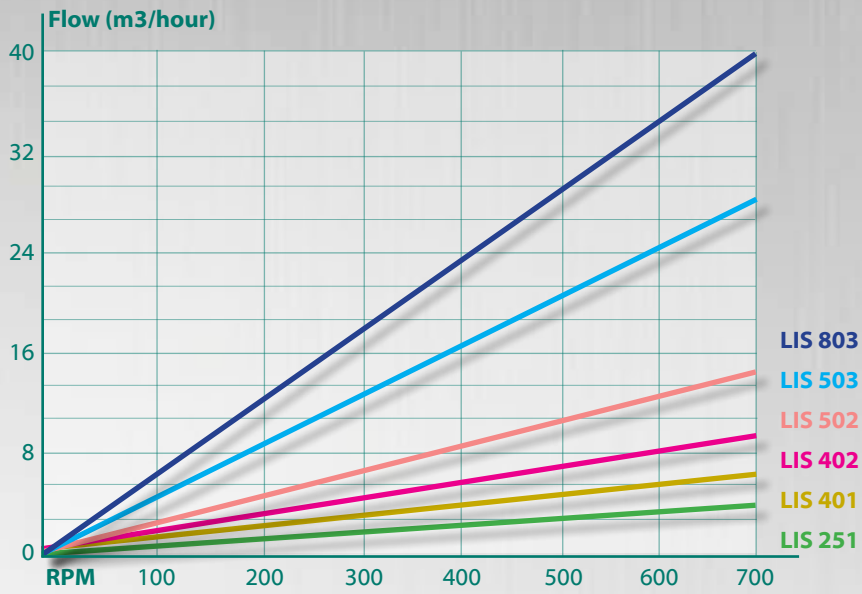

Size of pump	A	B	C	D	E	F	G	H	I	J	K	L
LIS 251	280	40	41,7	120	90	50	19	208	115	9	120	DN-25
LIS 401	292		47,7									DN-40
LIS 402	335	50	46,2	140	98	62	24	239	129	11	140	DN-40
LIS 502	347		52									DN-50
LIS 503	428	80	57,4	170	117	93	38	303	303	13	170	DN-50
LIS 803	450		70,4									DN-80



Boyser sanitary lobe pumps LIS SERIES

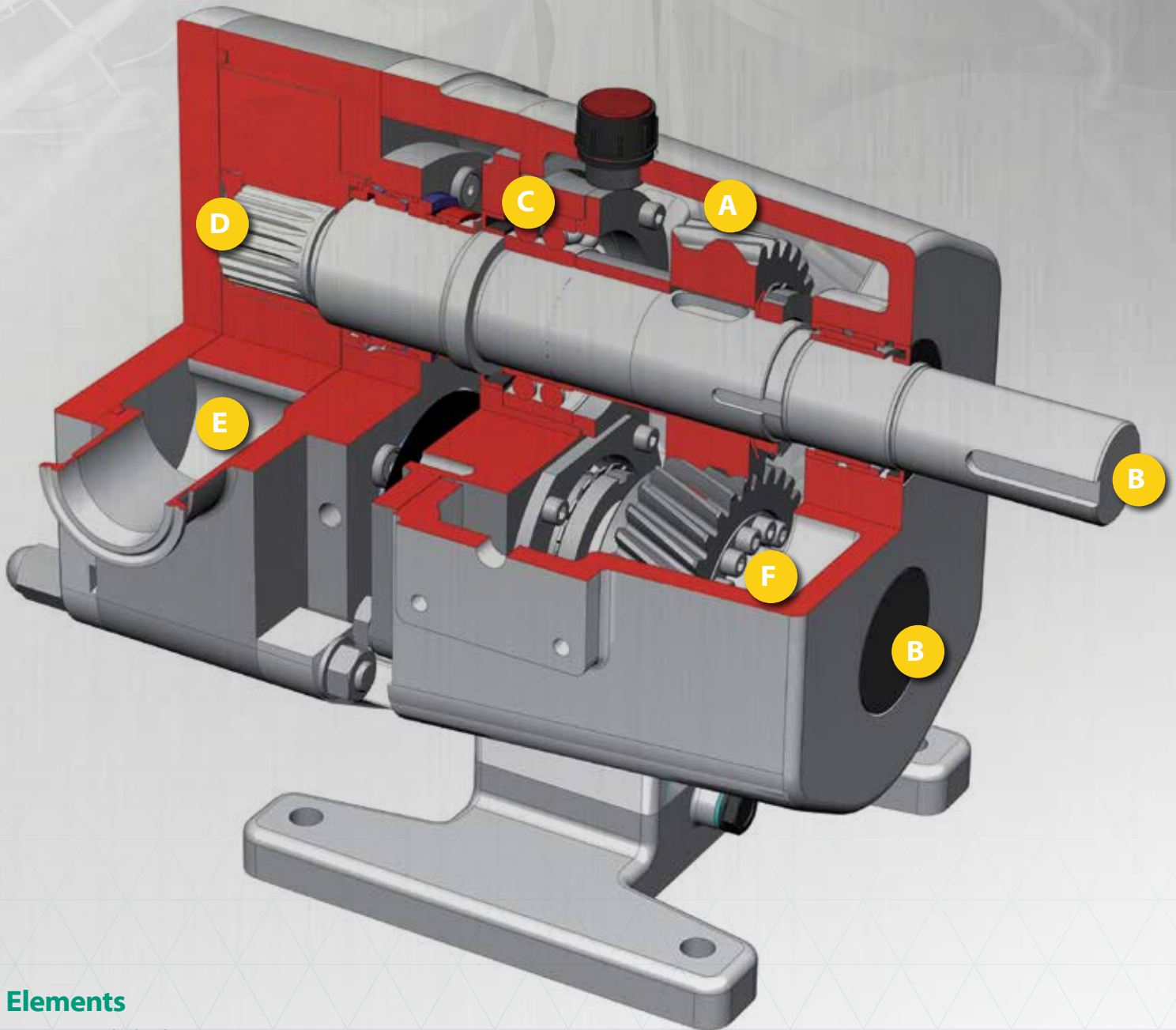

Elements

- A- Precision helical gears
- B- Interchangeable shaft (top / bottom position)
- C- Oversized bearings to cope with heavy loads
- D- Insertion of splined shaft to spread the load better and reduce the risk of wear
- E- All components in contact with the fluid are made of AISI-316 L stainless steel
- F- Perfectly adjusted synchronisation

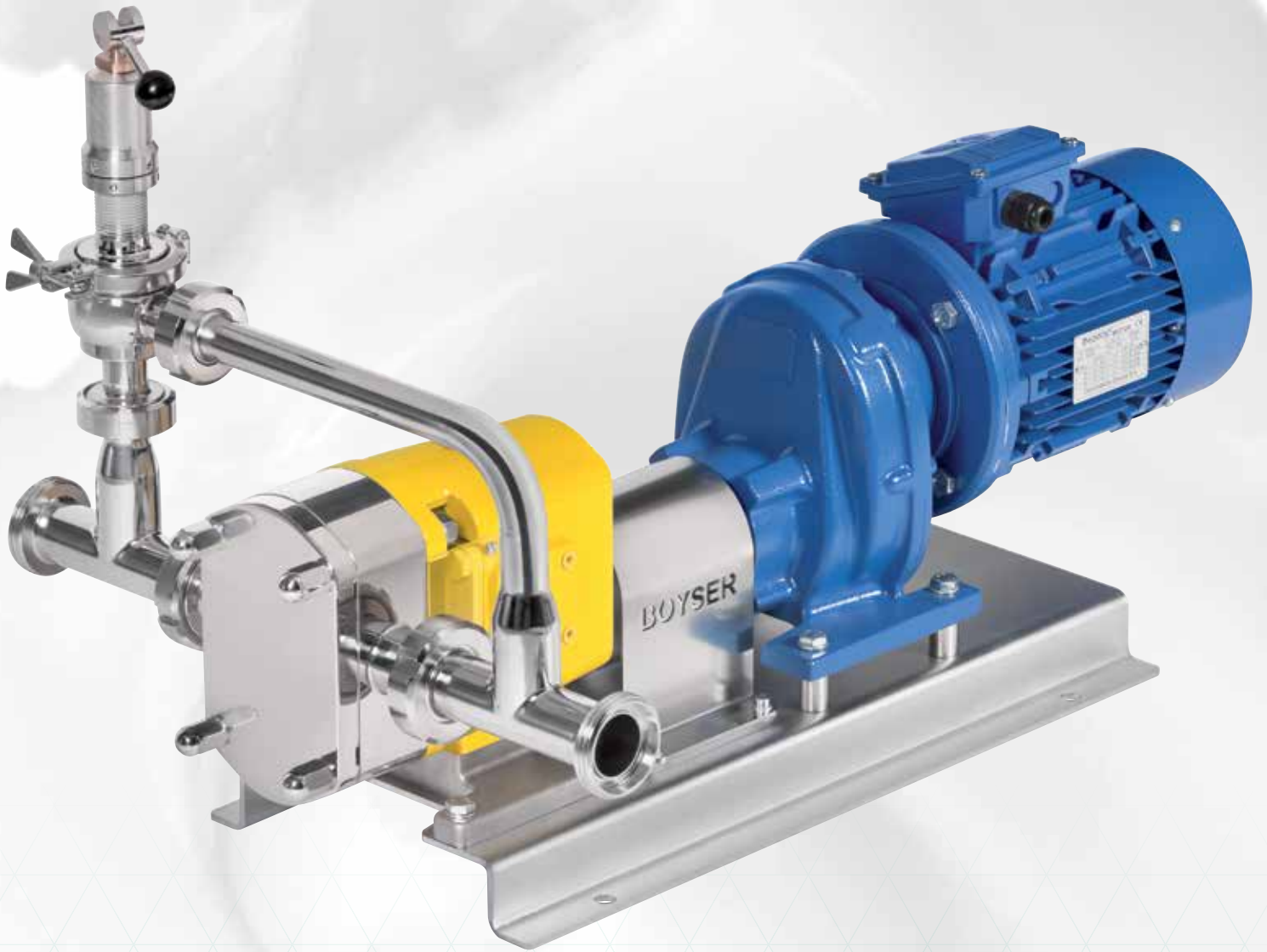

Boyser hygienic lobe pumps **LIH SERIES**



Lobe pump of hygienic design

Rotary lobe pump of hygienic design, recommended for use in the most demanding of sanitary applications, where ease of cleaning, a pump configured for automatic drainage and advanced mechanical closures deliver levels of safety that are capable of meeting the exacting certification standards of EHEDG.

Supplied by default with a standard surface roughness of $Ra \leq 0.8 \mu m$ ($Ra \leq 0.4 \mu m$ available as an option), in order to ensure the best possible treatment of the product being handled; with an obsessive attention to minimising possible contamination.

Created to meet exacting standards, with respect to the pumping of products of any viscosity, in the medical sector, test labs and the food and cosmetic industries.

Standard version with Tri-clamp connections, mechanical seals made of silicon carbide, graphite, EPDM; tri-lobe type rotors and sealing gaskets made of EPDM.

Main options:

- . DIN 11851 NW or SMS connections, with others available to order.
- . Bi-lobe rotors in dual wing configuration.
- . Sealing gaskets in NBR or FKM.
- . Safety by-pass valve between connections.
- . Rectangular feed inlet.
- . Heat insulating/cooling jacket.





Performance curve:

Flow (m³/hour)

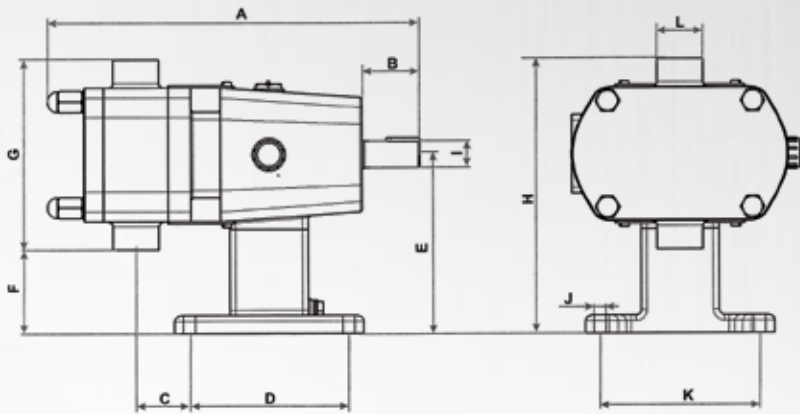
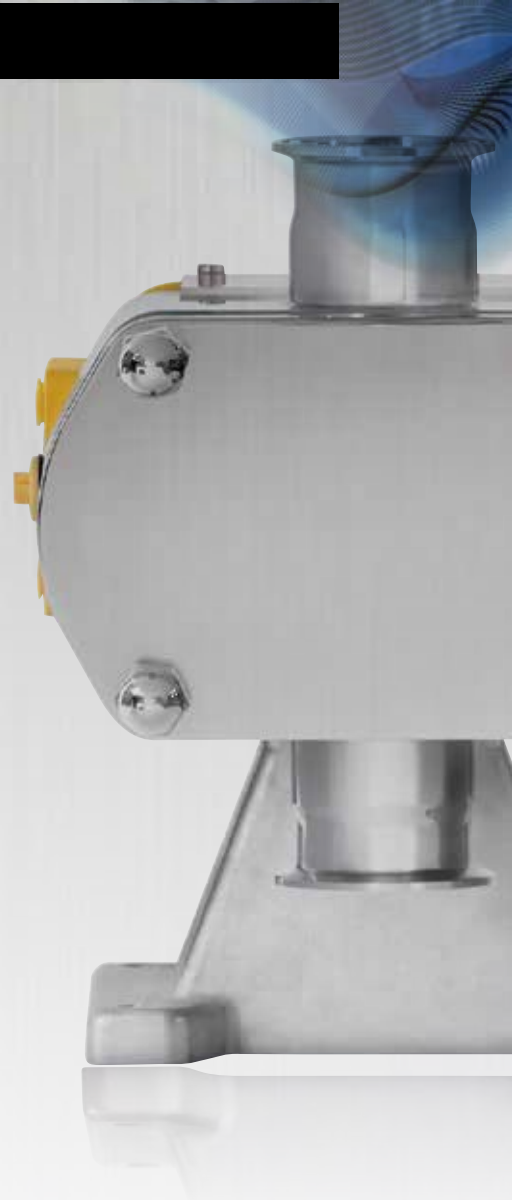
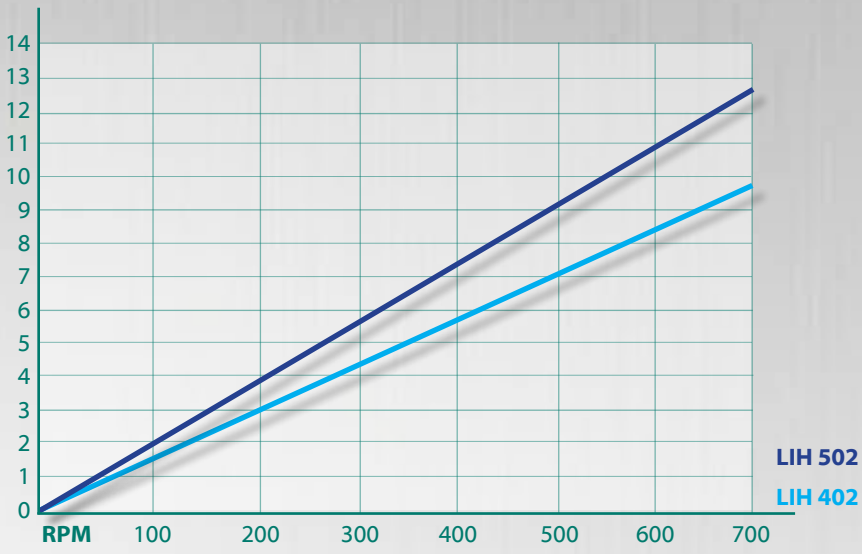

Size of pump	A	B	C	D	E	F	G	H	I	J	K	L
LIH 402	338	50	52	140	160	54	212	266	24	11	140	DN-40
LIH 502	350		58									DN-50

Boyser hygienic lobe pumps **LIH SERIES**

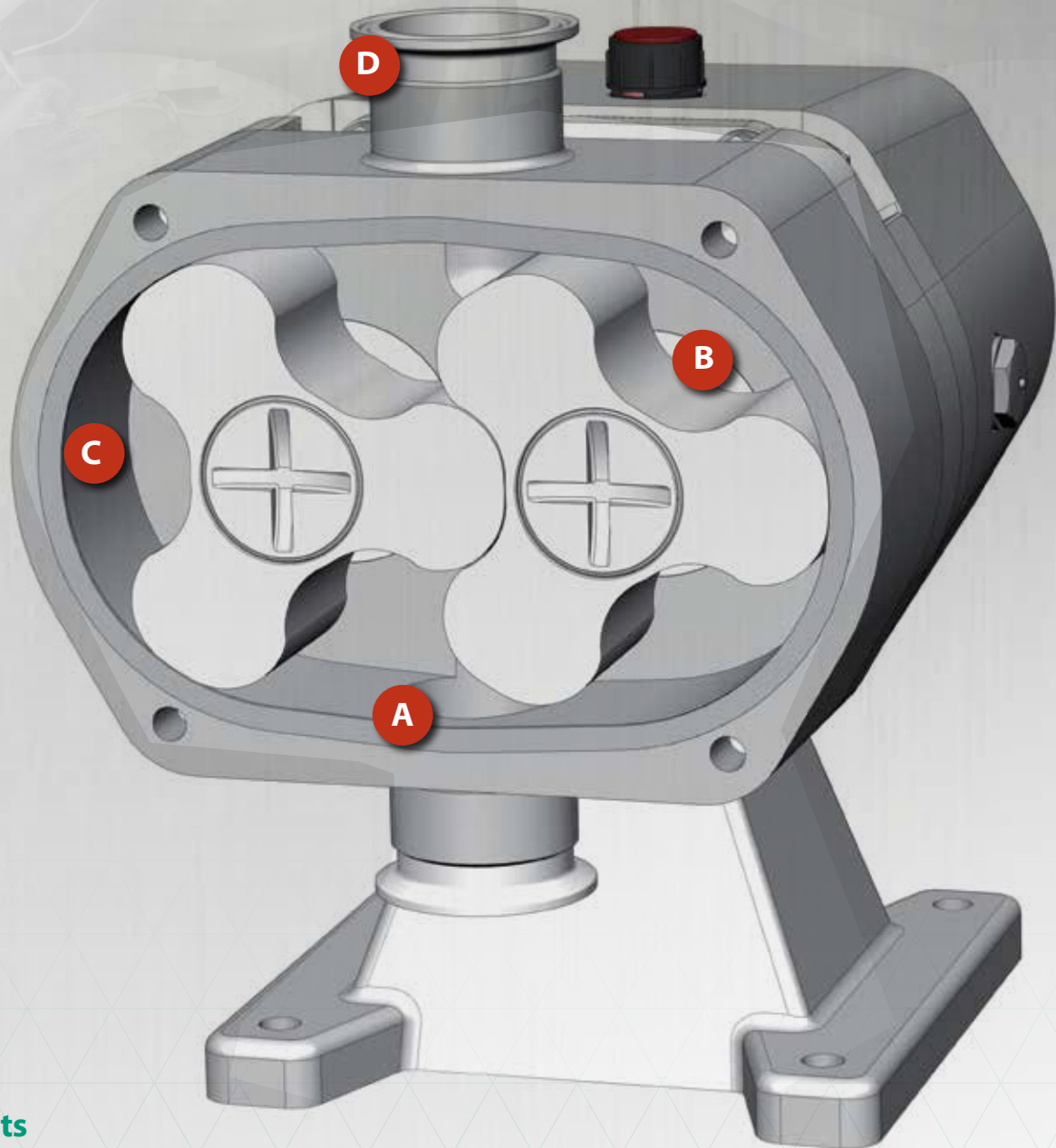

Elements

- A- Designed for automatic drainage
- B- Mechanical seals can be accessed or replaced via the front section
- C- Standard finish $Ra \leq 0.8$ (≤ 0.4 available as an option)
- D- Tri-clamp connections fitted as standard
- E- Modular configuration with stainless-steel base support

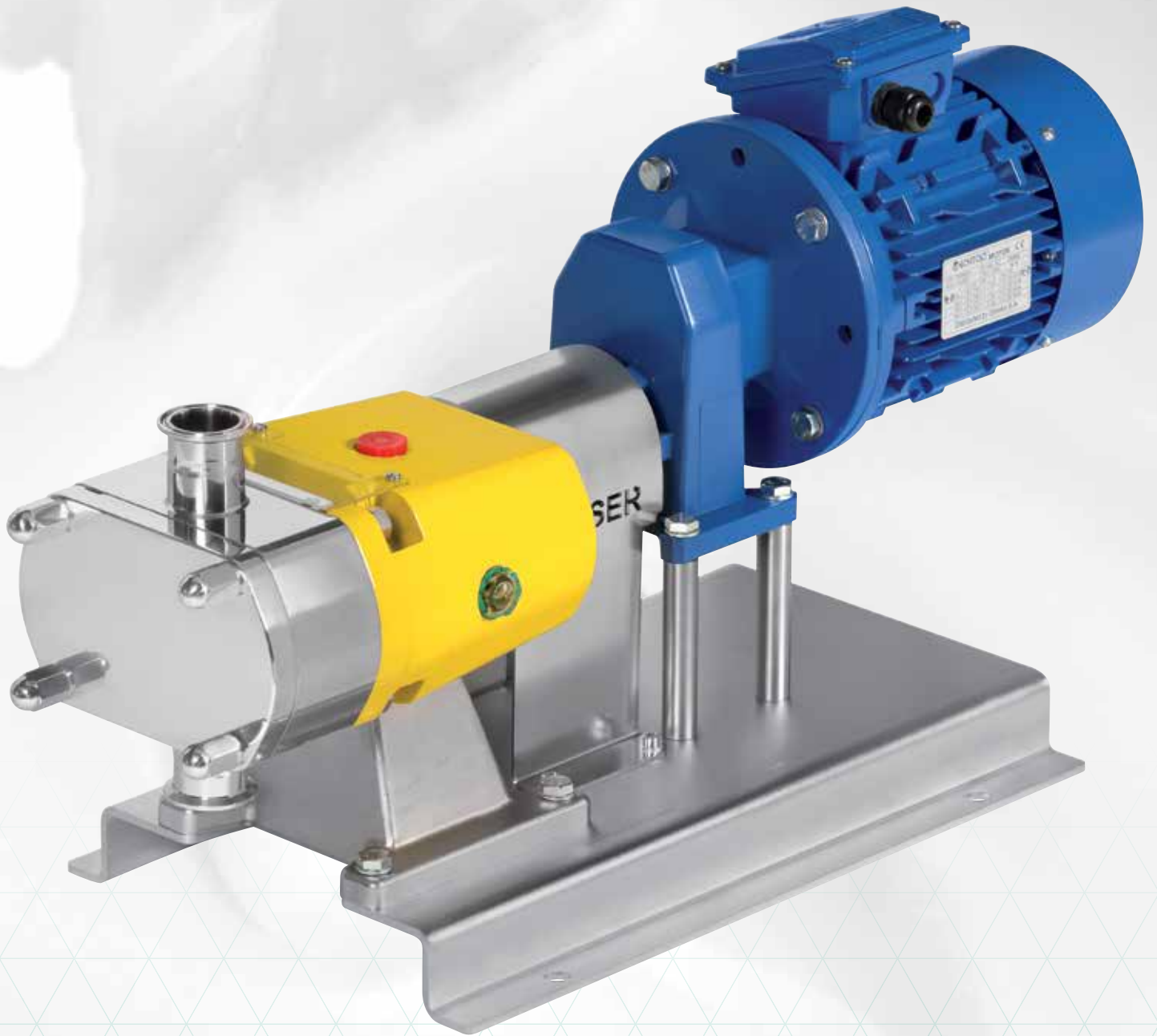

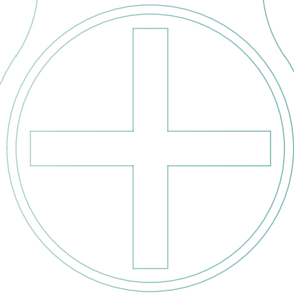
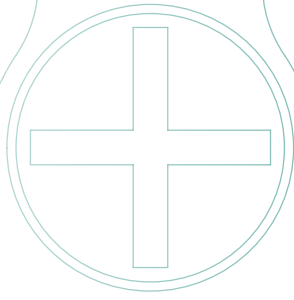
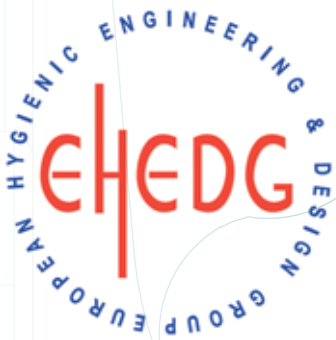

boyser®

Bombas Boyser, S.L. C/. Narcís Monturiol, 24 · Pol. Ind. Can Magre
Telf.: +34 93 844 77 78 · 08187 Sta. Eulàlia de Ronçana (BARCELONA, SPAIN)
info@boyser.com · www.boyser.com

