

boyser[®]

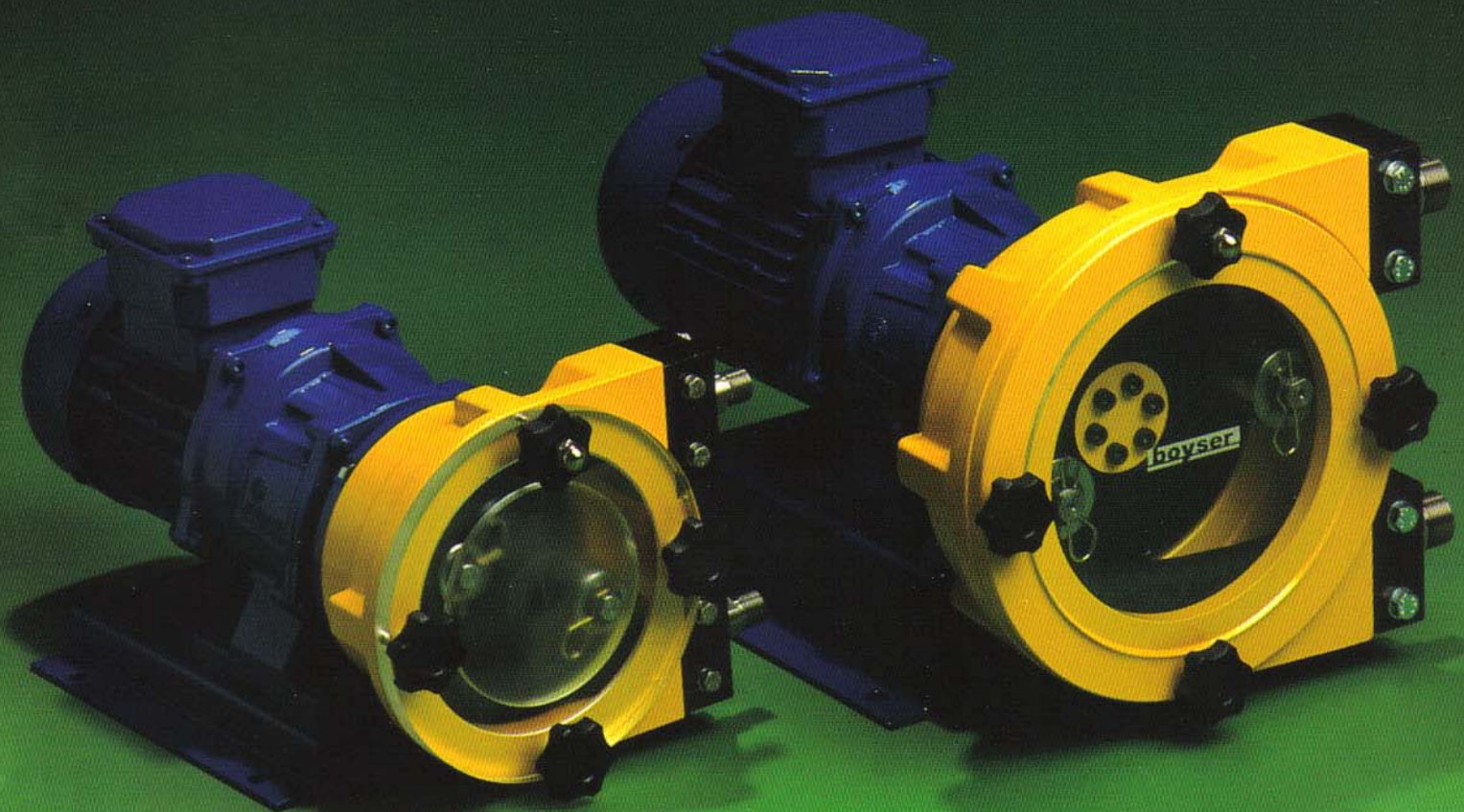

Industrial Peristaltic Pumps
AMP Series

SERIES AMP SERIE



DRIVERS • ACCIONAMIENTOS

- Gear-motor
Moto-reductor
- Motor variator with gear reducer
Moto-variador mecánico con reductor
- Gear motor with integrated inverter
Moto-reductor con convertidor de frecuencia integrado
- Pneumatic gear motor
Moto-reductor neumático

ACCESORIES • ACCESORIOS

- Tube leakage detector
Detector de rotura del tubo
- Pulsation dampener
Pulmón amortiguador de pulsaciones
- TRICLAMP, DIN 11851, SMS, NPT, PP, PVDF connections
Conexiones TRI-CLAMP, DIN 11851, SMS, NPT, PP, PVDF
- Electronic equipment for batch applications.
Equipo electrónico de dosificación

MODELS • MODELOS



	AMP-10	AMP-13	AMP-16/B	AMP-19/B	AMP-22
Capacity <i>Capacidad</i>	0,023 l/rev	0,038 l/rev	0,095 l/rev	0,123 l/rev	0,246 l/rev
Connections <i>Conexiones</i>	3/8"	3/8"	3/4"	1"	1"
Maximum pressure <i>Presión máxima</i>	8 bar	8 bar	8 bar	2 bar	8 bar
Pressing tube system <i>Sistema de apriete del tubo</i>	Rollers <i>Rodillos</i>	Rollers <i>Rodillos</i>	Rollers <i>Rodillos</i>	Rollers <i>Rodillos</i>	Rollers <i>Rodillos</i>
Available tubes in rubber <i>Tubos disponibles en caucho</i>	NR NBR EPDM HYPALON NR-A NBR-A	NR NBR EPDM HYPALON NR-A NBR-A	NR NBR EPDM HYPALON NR-A NBR-A		NR NBR EPDM HYPALON NR-A NBR-A
Available tubes in thermoplastic <i>Tubos disponibles en termoplástico</i>	NORPRENE SANTOPRENE	NORPRENE SANTOPRENE	NORPRENE SANTOPRENE TYGON	NORPRENE SANTOPRENE TYGON	SANTOPRENE

Main characteristics

- Suction lift to 8 metres
- Can run dry without damage
- Dosing application $\pm 1\%$
- Resistant to abrasion
- Resistant to corrosion
- Easy and economical maintenance
- Robust and versatile
- Easy to clean
- Connections in stainless-steel AISI-316

Drivers

- Gear motor
- Motor variator + gear reducer
- Gear motor with integrated inverter
- Air-powered gear motor



Examples of applications

- Lime slurry
- Bentonite
- Ceramic enamels
- Inks
- Paints
- Latex
- Resins
- Food products
- Jams
- Sauces
- Polymers
- Glues
- Colourings
- Detergents
- Acids
- Dairy

Accessories

- Pulsation dampener
- Detector to warn of leakage of the hose
- Electronic equipment for batch applications
- Connections in PP or PVDF

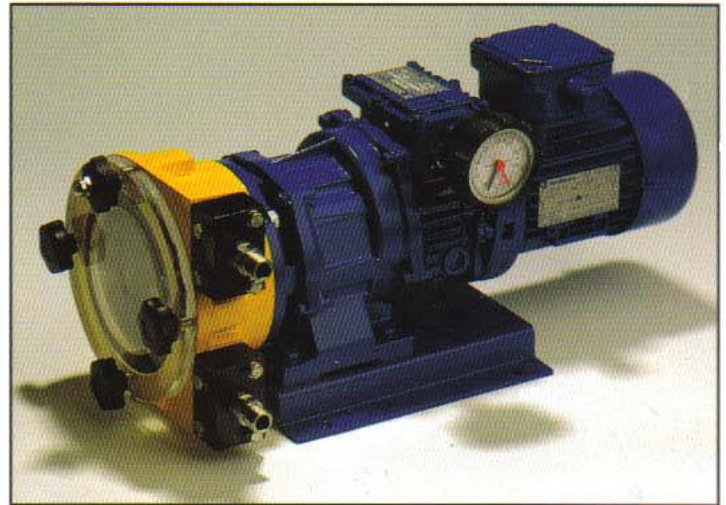

Dimensions

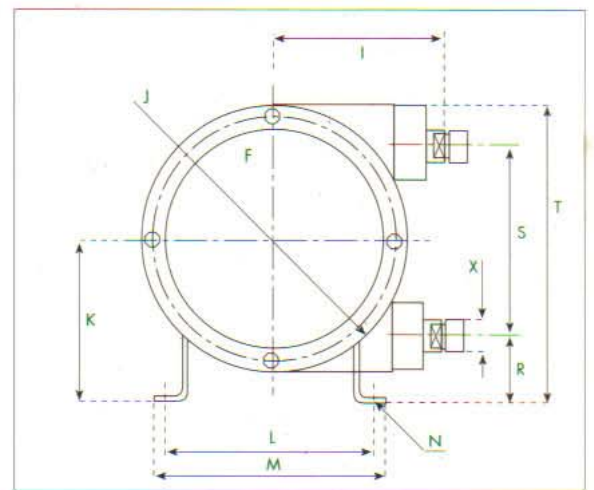
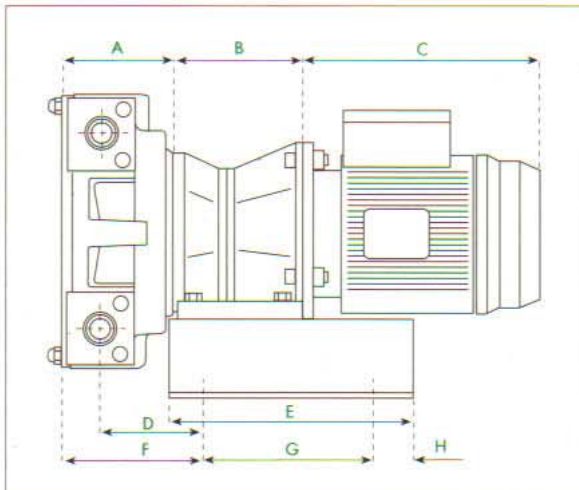

Model	A	B	C	D	E	F	G	H	I	J	K	L	M	N	R	S	T	X
AMP 10/13	80	•	•	71	220	108	160	30	130	Ø176	117	190	210	Ø9	60	115	210	3/8" BSP or NPT
AMP 16	120	•	•	93	220	130	160	30	155	Ø240	145	190	210	Ø9	60	170	265	3/4" BSP or NPT
AMP 19	120	•	•	93	220	130	160	30	155	Ø240	145	190	210	Ø9	60	170	265	1" BSP or NPT

• To be confirmed according to power and type of driver.

boyser[®]

e-mail: bombas@boyser.com
<http://www.boyser.com>

Distributor: _____