

HY - L-Motor

(Gehäusenendruck / Casing Pressure 20bar)

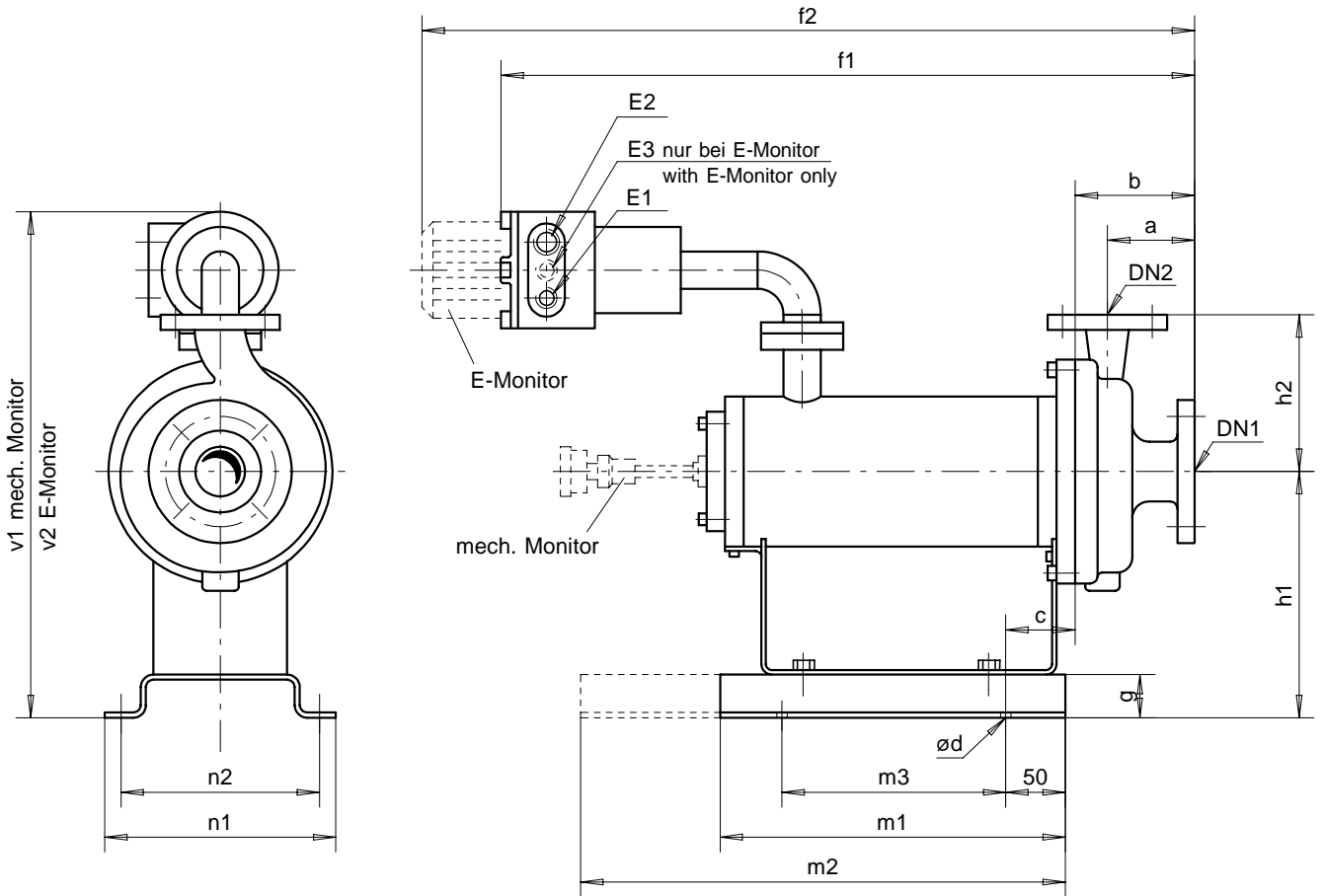

Maße / Dimensions in [mm]
Gewichte / Weights in [kg]

Modell	DIN DN1	PN40 DN2	ANSI #150		a	b	c	ød	f1	f2	g	h1	h2	m1	m2	m3	n1	n2	v1	v2	E1	E2	E3	Gew. Wt.
HY21A-L	50	32	2"	1 1/2"	80	106	61	15	773	886	40	240	140	318	468	218	210	185	570	579	M20	M32	M20	-
HY21B-L						105	61		772	885			140											-
HY21C-L						106	61		773	886			160											-
HY22A-L	50	32	2"	1 1/2"	80	115	61	15	782	895	40	240	140	318	468	218	210	185	570	579	M20	M32	M20	-
HY22B-L						112	61		779	892			140											-
HY22C-L						105	63		774	887			160											-
HY22D-L						112	65		783	896			180											-
HY23A-L	65	50	2 1/2"	2"	80	125	61	15	792	905	40	240	160	318	468	218	210	185	570	579	M20	M32	M20	-
HY23B-L						120	65		791	904			160											-
HY23C-L						114	63		783	896			180											-
HY24A-L	80	65	3"	2 1/2"	100	155	65	15	826	939	40	240	160	318	468	218	210	185	570	579	M20	M32	M20	-
HY24B-L						152	65		823	936			180											-